

Description

The enhancement mode MOS is extremely high density cell and low on-resistance.

Dimensions SOT-23

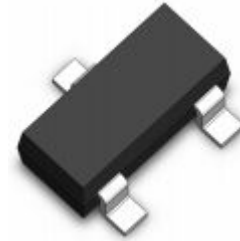

Pin Configuration

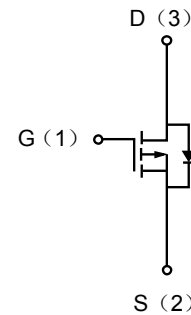

MOSFET Product Summary		
$V_{DS}(V)$	$R_{DS(on)}(\Omega)$	$I_D(A)$
-20	0.08 @ $V_{GS}=-4.5V$	-2.8
	0.11 @ $V_{GS}=-2.5V$	

Electrical characteristics per line @25 °C (unless otherwise specified)

Parameter	Symbol	Conditions	Min.	Typ.	Max.	Units
OFF CHARACTERISTICS						
Drain-Source Breakdown Voltage	BV_{DSS}	$I_D = -250\mu A, V_{GS} = 0V$	-20	-	-	V
Zero Gate Voltage Drain Current	I_{DSS}	$V_{DS} = -20V, V_{GS} = 0V$	-	-	-1	μA
Gate-Body Leakage Current	I_{GSS}	$V_{DS} = 0V, V_{GS} = \pm 10V$	-	-	± 100	nA
Gate Threshold Voltage	$V_{GS(th)}$	$V_{DS} = V_{GS}, I_D = -250\mu A$	-0.45		-0.9	V
Static Drain-Source On-Resistance	$R_{DS(ON)}$	$V_{GS} = -4.5V, I_D = -2.8A$	-	0.08	0.11	Ω
		$V_{GS} = -2.5V, I_D = -2.0A$	-	0.11	0.15	Ω
Forward Tran conductance	g_{FS}	$V_{GS} = 5V, I_D = 50mA, T_A = 125^\circ C$		6.5		S
DYNAMIC PARAMETERS						
Input Capacitance	C_{ISS}	$V_{GS} = 0V, V_{DS} = 10V, f = 1MHz$	-	360		pF
Output Capacitance	C_{DSS}		-	125		pF
Reverse Transfer Capacitance	C_{RSS}		-	50		pF
SWITCHING PARAMETERS						
Turn-On Delay Time	$t_{d(on)}$	$V_{DD} = -6V, V_{GS} = -4.5V, R_L = 6\Omega, R_G = 6\Omega, I_D = -1A$	-		17	ns
Turn-Off Delay Time	$t_{d(off)}$		-		35	ns

Absolute maximum rating@25°C

Rating		Symbol	Value	Units
Drain-Source Voltage		V_{DS}	-20	V
Gate-Source Voltage		V_{GS}	± 8	V
Drain Current	Continuous	I_D	-2.8	A
	Pulsed	I_D	-8	A
Total Power Dissipation	$T_A=25^\circ\text{C}$	P_D	900	mW
	$T_A=125^\circ\text{C}$	P_D	570	mW

Typical Characteristics

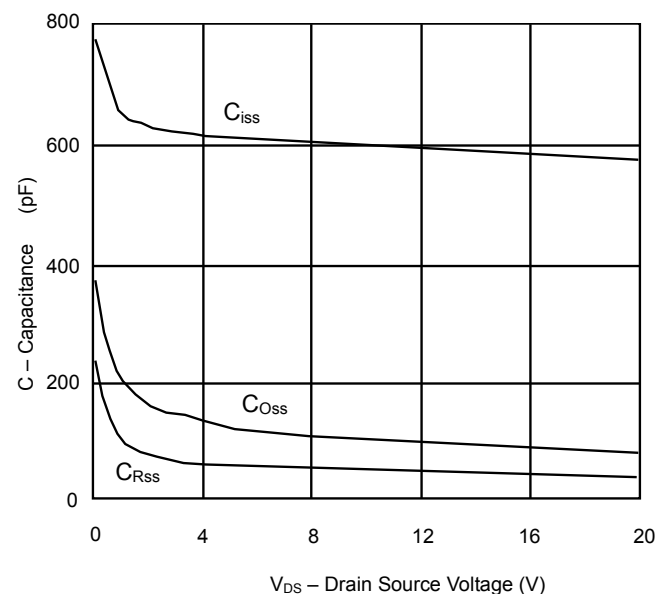
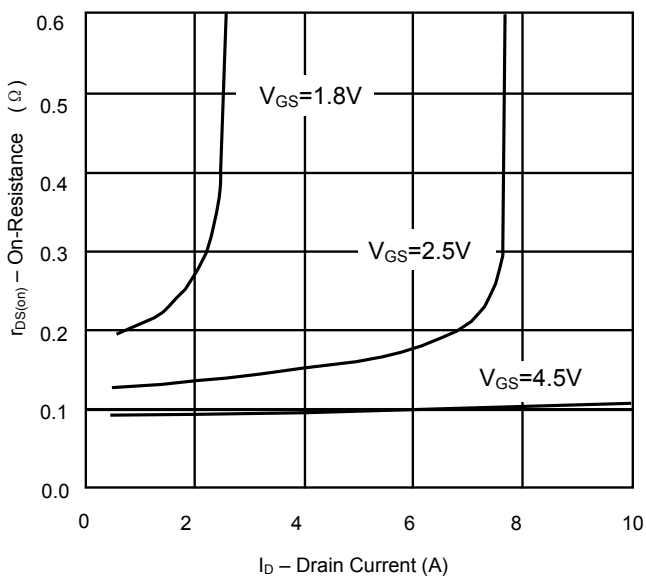
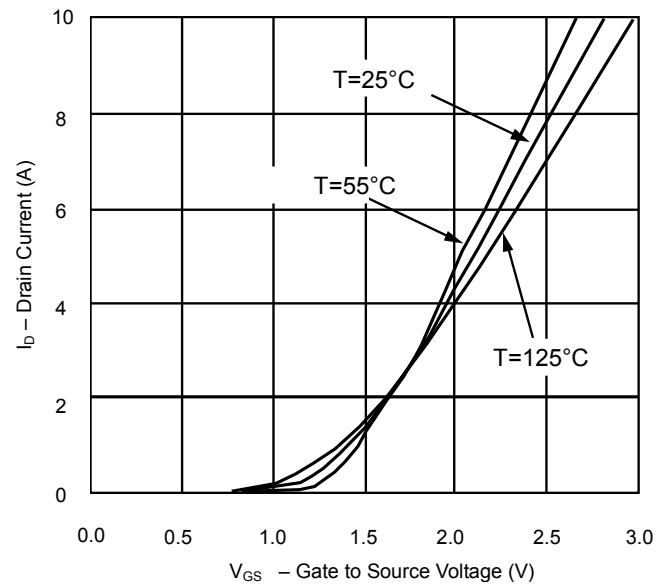
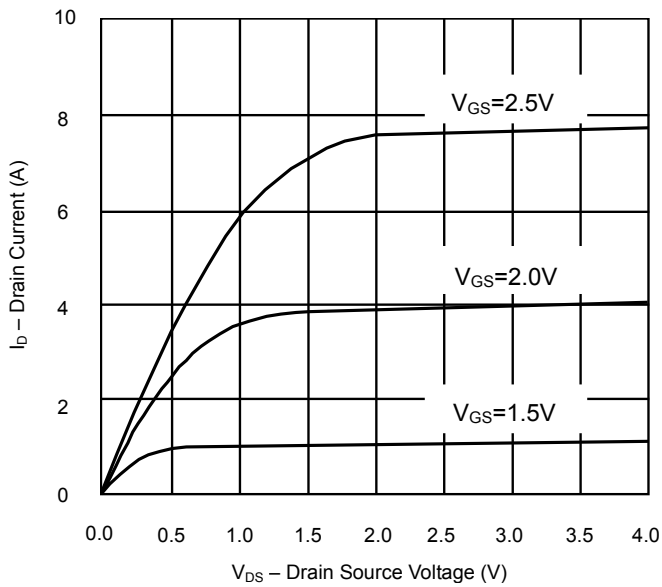

SOT-23 Package Outline & Dimensions

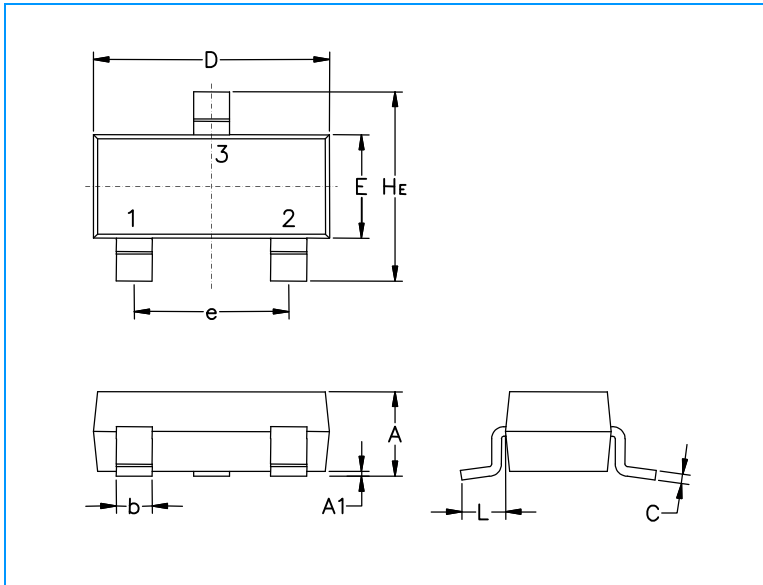

Symbol	Millimeters			Inches		
	Min.	Nom.	Max.	Min.	Nom.	Max.
A	0.89	1.00	1.11	0.035	0.040	0.044
A1	0.01	0.06	0.10	0.001	0.002	0.004
b	0.37	0.44	0.50	0.15	0.18	0.020
c	0.09	0.13	0.18	0.003	0.005	0.007
D	2.80	2.90	3.04	0.110	0.114	0.120
E	1.20	1.30	1.40	0.047	0.051	0.055
e	1.78	1.90	2.04	0.070	0.075	0.081
L	0.35	0.54	0.69	0.014	0.021	0.029
He	2.10	2.40	2.64	0.083	0.094	0.104

Soldering Footprint

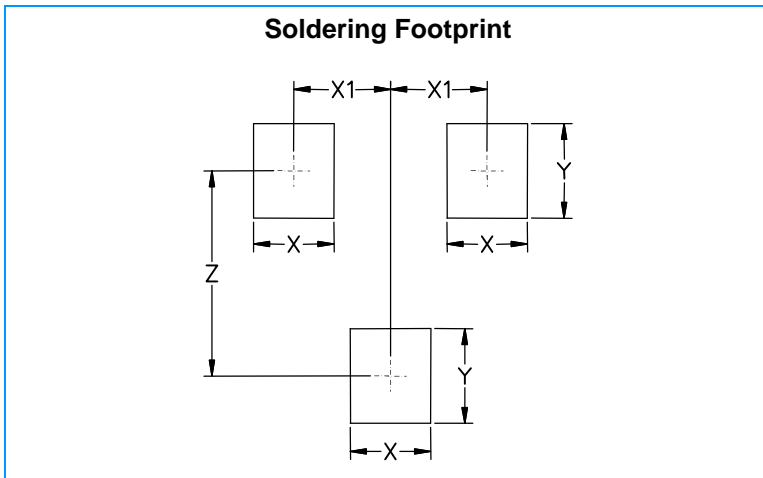

Symbol	Millimeters	Inches
X	0.80	0.031
X1	0.95	0.037
Y	0.90	0.035
Z	2.00	0.079